

OPERATING INSTRUCTIONS FOR COMBI-PUBLIC

1. The preset factory code is **0-0-0-0**.

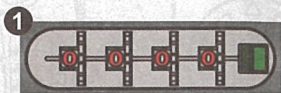

2. To change the secret code.

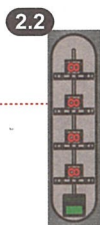
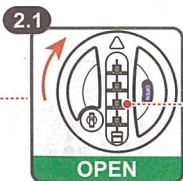
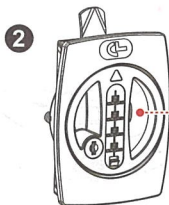

2.1 Rotate the handle to **OPEN** position.

2.2 The new secret code can now be set, e.g. **8-8-8-8**.

The process is complete.

3. In order to **LOCK**

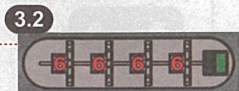
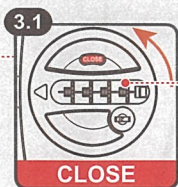
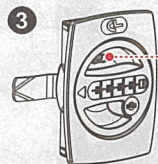

3.1 Rotate the handle to **CLOSE** position.

3.2 Turn the dials to any number for locking.

4. In order to **UNLOCK**

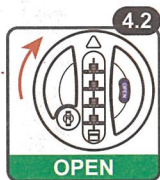
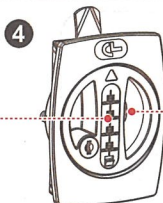
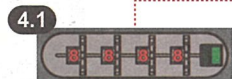

4.1 Turn the dials to the previously set secret code, e.g. **8-8-8-8**.

4.2 Rotate the handle to **OPEN** position.

Remarks : The secret code for **COMBI-PUBLIC** can be reset only when the lock is in **OPEN** position.